



## RECYCLED CONTENT BAGS

Designed for those looking for a more sustainable solution to their flexible packaging needs, our offering includes the most popular sizes of Reclosable Bags, Merchandise Bags, Poly Mailers and Can Liners. All product is manufactured with a percentage of Post-Consumer Recycled (PCR) or Post-Industrial Recycled (PIR) material. This means that a portion of plastic is kept out of landfills and instead reused to create your bag.

### POST-CONSUMER AND POST-INDUSTRIAL MATERIAL

Post-Consumer material is derived from waste that has been used by a consumer, disposed of, and diverted from the waste stream — things like the aluminum cans, plastic bottles and bags, and newspapers that you place in your recycling bin for pick-up. Post-Industrial material comes from resin that has been processed but not sold as prime material. It is instead sold to another party and reground for reuse.



### POLY MAILERS WITH 50% RECYCLED CONTENT

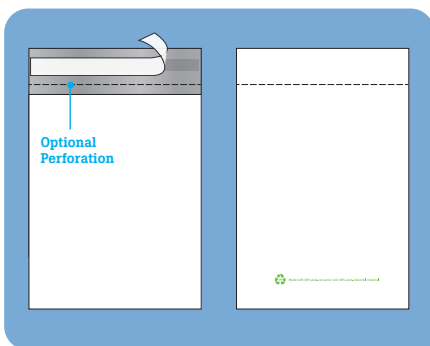

Made from a coextruded blend of Low-Density Polyethylene with 30% PCR and 20% PIR for the secure shipment of items. These have the following product features:

- ▶ White outside and silver inside in 2.5 mil
- ▶ Permanent adhesive closure
- ▶ Perforated (for easy opening) or non-perforated
- ▶ Tamper proof and waterproof
- ▶ Side weld construction
- ▶ Print up to 3 colors on 2 sides (spot print)\*
- ▶ Printed with a standard recycle message or can be changed to your custom message.

\* Cannot print all the way to the edges, requires a 1/2" border around the bag.

MORE OPTIONS:  
Non-Perforated or Perforated,  
Printing, Packaging Details

### STOCK OPTIONS

ITEM	W x L	LIP	CNT	WT
<b>NON-PERFORATED - PRINTED</b>				
19135	10 X 13	1.5"	1000	24
19145	12 X 15.5	1.5"	500	17
19155	14.5 X 19	1.5"	500	25
19165	19 X 24	1.5"	200	17
<b>PERFORATED - PRINTED</b>				
19130	10 X 13	1.5"	1000	24
19140	12 X 15.5	1.5"	500	17
19150	14.5 X 19	1.5"	500	25
19160	19 X 24	1.5"	200	17

### CUSTOM OPTIONS

W x L	LIP	CNT	WT
7.5 X 10.5	1.5"	1000	17
9 X 12	1.5"	1000	22
10 X 13	1.5"	1000	26
12 X 15.5	1.5"	500	19
14.5 X 19	1.5"	500	27
19 X 24	2"	200	18
24 X 24	2"	200	22

CONTACT US FOR  
MORE INFORMATION

136 Wayside Avenue  
West Springfield, MA 01089

# SUSTAINABLE SOLUTIONS

## LOW-DENSITY WHITE MERCHANDISE BAGS WITH 25% PCR

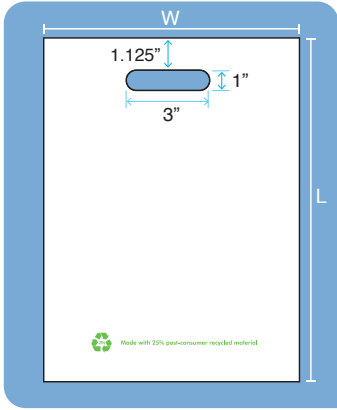

Made from a blend of 100% virgin Low and Linear Low-Density Polyethylene and 25% Post-Consumer Recycled (PCR) material in 2.25 mil. These have the following product features:

- ▶ White color film in 2.25 mil
- ▶ Standard 3" die cut handles
- ▶ Side weld construction
- ▶ Print up to 8 colors on 2 sides (spot and process print)\*
- ▶ Printed with a standard recycle message or can be changed to your custom message.

\* Cannot print all the way to the edges, requires a 1/2" border around the bag.

### 25% RECYCLED MATERIAL

ITEM	W x L	CNT	WT
<b>NO GUSSET</b>			
6725	9 X 12	1000	16
6727	12 X 15	1000	27

### 4" BOTTOM GUSSET

6730	15 X 19	500	23
6735*	18 X 19	500	28

\* Item 6735 has a Patch handle.

## RECLOSABLES WITH 25% PCR

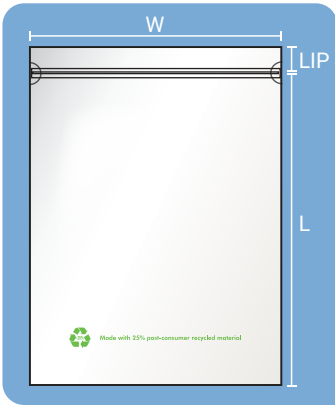

Made from a blend of Low-Density Polyethylene with 25% PCR for secure open and closure. These have the following product features:

- ▶ Clear film in 2 or 4 mil
- ▶ Secure single track zipper closure
- ▶ Measured in usable space (below the zipper)
- ▶ Side weld construction
- ▶ Hammer sealed zipper adds strength (reduces opening by 1/2")
- ▶ Print up to 3 colors on 2 sides (spot print)\*
- ▶ Printed with a standard recycle message or can be changed to your custom message.

### 25% RECYCLED MATERIAL

ITEM	W x L	CNT	WT
<b>2 MIL</b>			
19230	4 X 6	1000	4
19233	6 X 6	1000	6
19235	6 X 9	1000	9
<b>4 MIL</b>			
19237	6 X 9	1000	17
19239	9 X 12	1000	32

CONTACT US FOR  
MORE INFORMATION

136 Wayside Avenue  
West Springfield, MA 01089